

D series touch panel



D4



1. Technical Specs:

- Input Voltage: DC12V-24V
- Load Current: 4A×4CH Max 16A
- Grey Scale Level: 4096×4096×4096×4096
- Max Output Power: 192W/384W(12V/24V)
- Working Temperature: -20°C~60°C
- Dimensions: L86×W86×H36(mm)
- Package Size: L113×W112×H50(mm)
- Weight(G.W.): 208g

2. Installation Instruction:

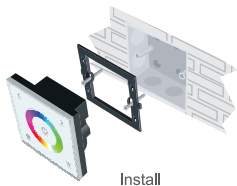

Install

1

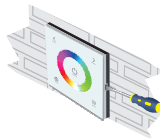

Uninstall

3. Key Functions:

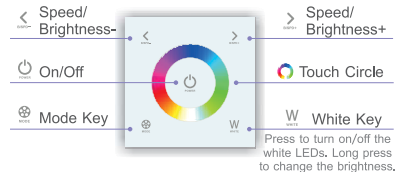

* Long press to turn on/off the tone.

The Changing Mode (Press to Switch):

- A. Static Red B. Static Green C. Static Blue D. Static Yellow E. Static Purple F. Static Cyan
 G. Static White H. RGB Skipping I. 7 Colors Skipping J. RGB Smooth K. 7 Colors Smooth

5. Wiring Diagram:

E.g 1: Connect with 12V Strip. Max 192W(12V)

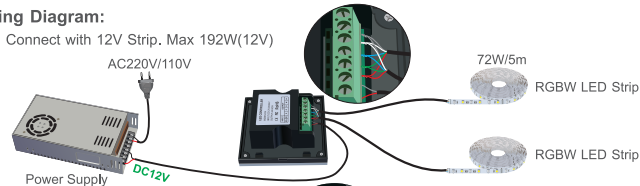

E.g 2: Connect with 24V Strip. Max 384W(24V)

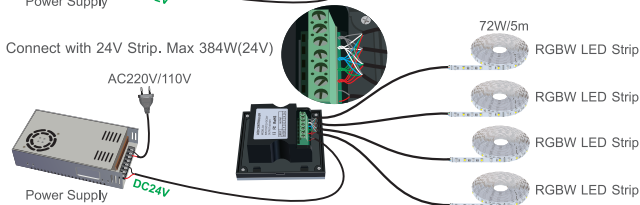

2

4. Green Block:

